

# Thredbo 14



14th International Conference  
on Competition and Ownership  
in Land Passenger Transport

CONFERENCE PROGRAM

Ritz-Carlton Hotel

Santiago, Chile

30 August to

3 September 2015



## Sunday 30 August 2015

18:00 - 20:00

Welcome Cocktail / Tierra Noble Restaurant (Reyes Lavalle 3310, Las Condes)

## Monday 31 August 2015

09:00 -10:30

Welcome from Pontificia Universidad Católica de Chile Authorities  
Opening Address: Minister of Transports and Telecommunications / Grand Ballroom

10:30 - 11:00

Morning tea

11:00 - 12:30

Operator roundtable / Grand Ballroom

12:30 - 13:00

Workshop rules / Grand Ballroom  
See pages 9-12 for details and location of your workshop

13:00 - 14:00

Lunch / Ritz Carlton Restaurant

14:00 - 16:00

Workshop 1

Workshop 2

Workshop 3

Workshop 4

Workshop 5

Workshop 6

Workshop 7

Workshop 8

16:00 - 16:30

Afternoon tea

16:30 - 18:00

W1

W2

W3

W4

W5

W6

W7

W8

## Tuesday 1 September 2015

08:00 - 10:00

W1

W2

W3

W4

W5

W6

W7

W8

10:00 - 10:30

Morning tea

10:30 - 12:30

W1

W2

W3

W4

W5

W6

W7

W8

12:30 - 13:30

Lunch / Ritz Carlton Restaurant

13:30 - 15:30

W1

W2

W3

W4

W5

W6

W7

W8

15:30 - 16:00

Afternoon tea

16:00 - 18:30

W1

W2

W3

W4

W5

W6

W7

W8

18:30 - 20:00

Cocktail Reception hosted by BRT Centre of Excellence / Maldito Chef Restaurant (Apoquindo 3300, Las Condes)

20:00 onwards

International Steering Committee dinner (by invitation only)

## Wednesday 2 September 2015

08:00 - 10:00

W1

W2

W3

W4

W5

W6

W7

W8

10:00 - 10:30

Morning tea

10:30 - 12:30

W1

W2

W3

W4

W5

W6

W7

W8

12:30 - 13:30

Lunch / Ritz Carlton Restaurant  
Michael Beesley Award meeting (by invitation only) / Boardroom A

13:30 - 15:30

Free time for delegates

15:30 - 21:30

Excursion to Santa Rita Vineyard  
Preparation of workshop reports (by chairs & rapporteurs only)  
Conference dinner and Michael Beesley Award at vineyard

## Thursday 3 September 2015

08:30 - 10:30

Keynote presentation by Michèle Dix. Workshops 1 - 2 Report / Grand Ballroom

10:30 - 11:00

Morning tea

11:00 - 13:00

Workshops 3 - 4 - 5 - 6 Report / Grand Ballroom

13:00 - 14:00

Lunch / Ritz Carlton Restaurant

14:00 - 15:00

Roundtable: Including all stakeholders / Grand Ballroom

15:00 - 16:00

Workshops 7 - 8 Report / Room: Grand Ballroom

16:00 - 16:30

Afternoon tea

16:30 - 18:30

Presentation of top four workshop papers & Closing Speeches including paper of Michael Beesley Award recipient

## Friday 4 September 2015

08:30 - 13:00

Technical tour / Departure from Ritz Carlton Hotel

# 14th International Conference on Competition and Ownership in Land Passenger Transport

## ORGANIZED BY

Department of Transport Engineering and Logistics, Pontificia Universidad Católica de Chile

Institute of Transport and Logistics Studies, The University of Sydney

Bus Rapid Transit Centre of Excellence

Center for Sustainable Urban Development - CEDEUS

## LOCAL ORGANIZING COMMITTEE

Juan Carlos Muñoz	Pontificia Universidad Católica de Chile
Felipe Delgado	Pontificia Universidad Católica de Chile
Patricia Galilea	Pontificia Universidad Católica de Chile
Luis Gutiérrez	Asociación Latino-Americana de Sistemas Integrados and Bus Rapid Transit Centre of Excellence
Darío Hidalgo	Embarq
Héctor Moya	Asociación de Concesionarios de Transporte Urbano de Superficie
Laurel Paget-Seekins	Pontificia Universidad Católica de Chile and Massachusetts Bay Transit Authority
Lake Sagaris	Pontificia Universidad Católica de Chile and Ciudad Viva
Carolina Simonetti	Dirección de Transporte Público Metropolitano
Ignacia Torres	Pontificia Universidad Católica de Chile

## INTERNATIONAL STEERING COMMITTEE

Professor David Hensher (Chair)	The University of Sydney, Australia
Professor Joaquim de Aragão	University of Brasília, Brazil
Brendan Finn	European Transport and Telematics Systems Ltd, Ireland
Professor Jan Owen Jansson	Linköping University, Sweden
Professor Rosário Macário	Instituto Superior Técnico, Portugal
Professor Juan Carlos Muñoz	Pontificia Universidad Católica de Chile, Chile
Professor John Preston	University of Southampton, UK
Professor John Stanley	The University of Sydney, Australia
Didier Van de Velde	Delft University of Technology and inno-V, The Netherlands
Professor Jackie Walters	University of Johannesburg, South Africa
Ruth Steel (Secretariat)	The University of Sydney, Australia

## SUPPORTERS

Bus Rapid Transit Center of Excellence

Centro de Desarrollo Urbano Sustentable

Institute of Transport and Logistics Studies, The University of Sydney

Metro de Santiago

Pontificia Universidad Católica de Chile



## SPONSORS

ACTUS

City Planning

Directorio de Transporte Público Metropolitano

Elsevier

GIRO

Grupo EFE

LOGIT Transportation Engineers

METBUS

PTV Group

SHIFT Workforce Management

SUBUS

Transit UC



# 1 Contents

<b>4</b>	<b>Welcome</b>	
<b>5</b>	<b>Conference Program</b>	
<b>9</b>	<b>Workshops Program</b>	
9	Workshop 1	Innovations in service delivery and performance management
9	Workshop 2	Effective institutional relationships, regulatory frameworks and contract transition strategies
10	Workshop 3	Sustainable funding sources, and related cost/benefit measurements, for public transport
10	Workshop 4	Developing inter-modal transport systems
11	Workshop 5	Harnessing big data
11	Workshop 6	Reassessing public operations
12	Workshop 7	Market initiative: regulatory design, implementation and performance
12	Workshop 8	The wider economic, social and environmental impacts of public transport investment
<b>13</b>	<b>Biographies</b>	
13	Plenary Speakers	
14	Roundtable Contributors	
15	Roundtable: Including all stakeholders	
16	Chairs & Rapporteurs	
<b>21</b>	<b>Attendees</b>	
<b>25</b>	<b>Michael Beesley Award</b>	
<b>26</b>	<b>Papers presented at Thredbo 14</b>	

# Welcome



Dear Delegate,

It gives me great pleasure to welcome you to the 14th International Conference on Competition and Ownership in Land Passenger Transport in Santiago, Chile. This conference is proudly hosted by Pontificia Universidad Católica de Chile.

Since its inception this conference series has established itself as the premier international forum dedicated to the analysis and debate of competition and ownership issues in land passenger transport. It has attracted high quality participation and delivered a large portfolio of impressive material synthesising developments not only from developed nations but increasingly from developing nations.

I would like to express my gratitude for the generous support of our sponsors and for the efforts of the local organising and international steering committees. These have greatly helped in making this conference, what we hope will be, the most successful in the series so far. I have every confidence you will be stimulated by the activities and discussions at this influential forum over the next few days. I particularly look forward to learning of the outcomes of the workshops. Enjoy the culture and heritage of Santiago and the excellent company!

**Professor David Hensher, FASSA**

Executive Chair and Co-founder of the Thredbo Series  
Director, Institute of Transport and Logistics Studies  
The University of Sydney Business School, Australia



Dear Delegate,

It is our privilege and honor to host the 14th Thredbo International Conference, which is jointly organized by the Department of Transport Engineering and Logistics of the Pontificia Universidad Católica de Chile, the Bus Rapid Transit Centre of Excellence and the Centro de Desarrollo Urbano Sustentable, CEDEUS.

This prestigious conference series has positioned itself as the most relevant to understand and improve the relation between urban transport regulatory agencies and public transport operators. Thredbo has served as a forum for the international community, integrating a mix of executives from public agencies and operating consulting companies with researchers and academics in a very unique discussion. The conference receives contributions from each of these groups and therefore participants will be exposed to academic developments, case studies and benchmark experiences.

The event has captured the attention of researchers worldwide; we received over 180 contributions from more than 30 countries on five continents. The recently formed Latin-American Association of Integrated Public Transport Systems and BRT, SIBRT, will run a meeting of their agencies in parallel to Thredbo, so we expect an interesting interaction between the members of these agencies and the more traditional Thredbo community.

We expect a lively, exciting week. On behalf of the local organizing committee, I would like to thank the International Steering Committee for giving us the opportunity to host Thredbo and the organizations and sponsors whose financial contribution and support have made it possible for us to host the 14th Thredbo in Chile.

**Juan Carlos Muñoz**

Chair of Thredbo 14  
Director of the Department of Transport Engineering and Logistics  
Director of the BRT Centre of Excellence  
Deputy Director, Principal Researcher,  
Center for Sustainable Urban Development (CEDEUS)

# 3 Conference Program

**Dress code: Smart casual, no suits or ties are required, even for the social events.**

## Sunday 30 August 2015

**18:00 - 20:00**    **Conference opens with welcome cocktail reception at Tierra Noble Restaurant (delegates check in)**  
Tierra Noble - Reyes Lavalle 3310, Las Condes

## Monday 31 August 2015

**08.00 - 9:00**    **Collection of delegate packs**

**09.00**    **Welcome - Grand Ballroom**  
Chair: Patricia Galilea, Pontificia Universidad Catolica de Chile  
Professor Juan Carlos de la Llera, Dean, School of Engineering, Pontificia Universidad Católica de Chile  
Professor Juan Carlos Muñoz - Conference Chair  
Director, Bus Rapid Transit Centre of Excellence and Director, Department of Transport Engineering and Logistics, Pontificia Universidad Católica de Chile

**09.15**    **Opening Address - Grand Ballroom**  
Andrés Gómez-Lobo, Minister of Transport and Telecommunications, Chile

**09.45**    **Wider benefits of public transport: an evolving concept with evolving uses**  
Glen Weisbrod, President, Economic Development Research Group

**10.30**    **Morning tea**

**11.00**    **Operator round table - Grand Ballroom**  
Chair: Professor Juan Carlos Muñoz, Director, Bus Rapid Transit Centre of Excellence and Director, Department of Transport Engineering and Logistics, Pontificia Universidad Católica de Chile  
Hector Moya, Director from Metbus and President of Association of Bus Operators in Santiago (ACTUS)  
Jesus Padilla, President of CISA (BRT Operator in Ciudad de Mexico, Mexico) and President of AMTM (Mexican Association of Transport and Mobility)  
Neil Smith, Director, Transit Systems

**12.30**    **Workshop rules - Professor David Hensher**  
Details of the eight workshops can be viewed on the Workshops page

**13.00**    **Lunch - Ritz Carlton Restaurant**

**14:00**    **Workshops sessions**

**16:00**    **Afternoon tea**

**16:30**    **Workshop sessions**

**18:00**    **Free evening**

## Tuesday 1 September 2015

- 8:00** Workshop sessions
- 10:00** Morning tea
- 10:30** Workshop sessions
- 12:30** Lunch
- 13:30** Workshop sessions
- 15:30** Afternoon tea
- 16:00** Workshop sessions
- 18:00** Close of workshop sessions
- 18:30** Cocktail reception hosted by Bus Rapid Transit Centre of Excellence at Maldito Chef Restaurant
- 20:00** International Steering Committee dinner (by invitation only)

## Wednesday 2 September 2015

- 8:00** Workshop sessions
- 10:00** Morning tea
- 10:30** Workshop sessions
- 12:30** Lunch
- Michael Beesley Award meeting** (by invitation only)
- 13:30** Free time for delegates
- Preparation of workshop reports**
- 15:30** Excursion to Santa Rita Vineyard (walk, wine tasting and vineyard museum)
- 19:00** Conference dinner and Michael Beesley Award at vineyard

## Thursday 3 September 2015

- 8:30** Chair: Julio Briones  
Dr Michèle Dix CBE, Managing Director of Crossrail 2, Transport for London, UK
- 9:30** Workshop 1 report  
Innovations in service delivery and performance management
- 10:00** Workshop 2 report  
Effective institutional relationships, regulatory frameworks and contract transition strategies
- 10:30** Morning tea
- 11:00** Workshop 3 report  
Sustainable funding sources, and related cost/benefit measurements, for public transport
- 11:30** Workshop 4 report  
Developing inter-modal transport systems
- 12:00** Workshop 5 report  
Harnessing big data
- 12:30** Workshop 6 report  
Reassessing public operations
- 13:00** Lunch



**14:00 Roundtable: Including all stakeholders: The “Other” Voices we need to achieve more sustainable transport.**

Successful transportation systems require cooperation, communication, and coordination between multiple stakeholders, but two key groups are often left out of the discussions: riders and workers. Transit operators (whether public or private) are not the same as their frontline employees and public authorities do not have the same perspective or interests as riders and civil society. The representatives of workers and rider organizations on this panel will discuss their role in the transition to formalized urban bus transport with a focus on our host city Santiago.

Chair: Dr Lake Sagaris, Pontificia Universidad Católica de Chile and Ciudad Viva

Panel: Miguel Matus, President Fenamet Union Federation

Enrique Montalva, Vice-president of the Civil Society Council La Florida municipality of Metropolitan Santiago

Dr Laurel Paget-Seekins, Massachusetts Bay Transportation Authority

**15:00 Workshop 7 report**

Market initiative: regulatory design, implementation and performance

**15:30 Workshop 8 report**

The wider economic, social and environmental impacts of public transport investment

**16:00 Afternoon tea**

**16:30 Presentation of top four workshop papers, including paper of Michael Beesley Award recipient**

**18:15** Chair: Professor David Hensher

Closing speeches

Professor Juan Carlos Muñoz - Conference Chair

Director, Bus Rapid Transit Centre of Excellence and Director, Department of Transport Engineering and Logistics, Pontificia Universidad Católica de Chile

Professor David Hensher - International Conference Series Chair

Director, Institute of Transport and Logistics Studies, The University of Sydney, Australia

**18:30 Conference closes**

## **Friday 4 September 2015**

**8:30 - 13:30 Technical Tour - Departure from Ritz Carlton Hotel**

On Friday morning, previously registered delegates have the opportunity to learn about Transantiago by visiting three centres that help in the operation of Santiago's transportation system:

- **Traffic Management Centre (UOCT)**, in charge of controlling the traffic lights of 2,600 junctions in Santiago.
- **Bus Monitoring Centre**, responsible for tracking the operation of 6,300 buses.
- **Metro Monitoring Centre**, in charge of supervising 140 metro trains circulating Santiago every day.

During the visit, delegates will travel on Transantiago's buses and Metro and visit some important terminals of the public transport system.

Site Plan

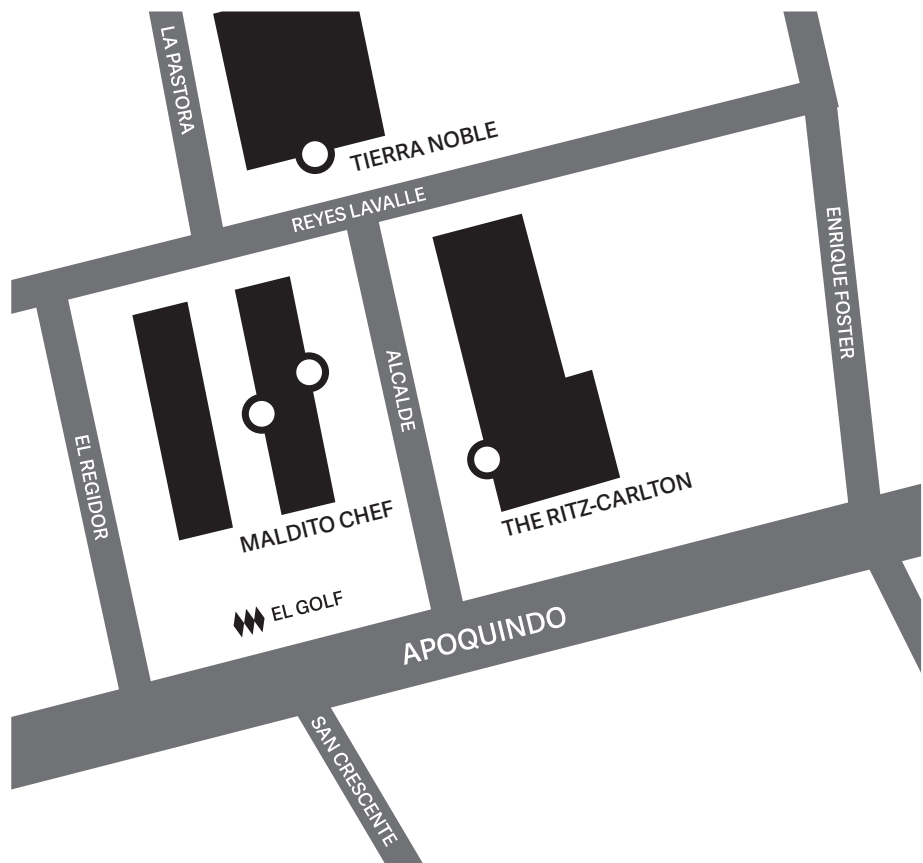

Venue Plans

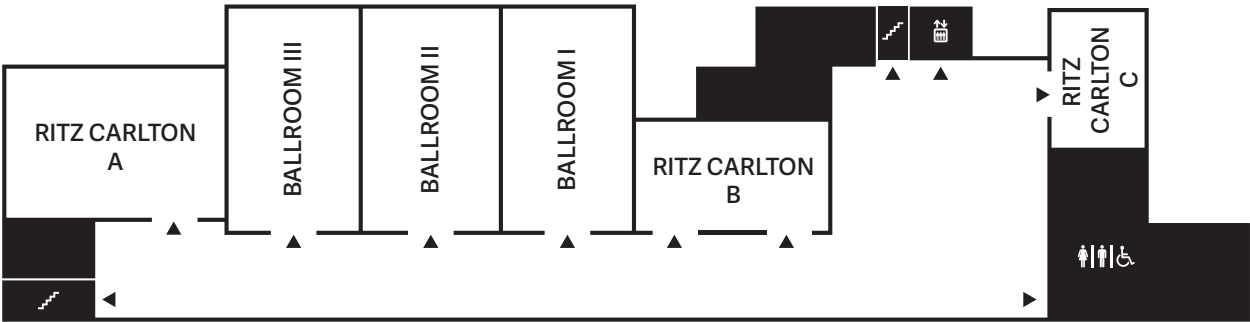

BALLROOM LEVEL (-2)

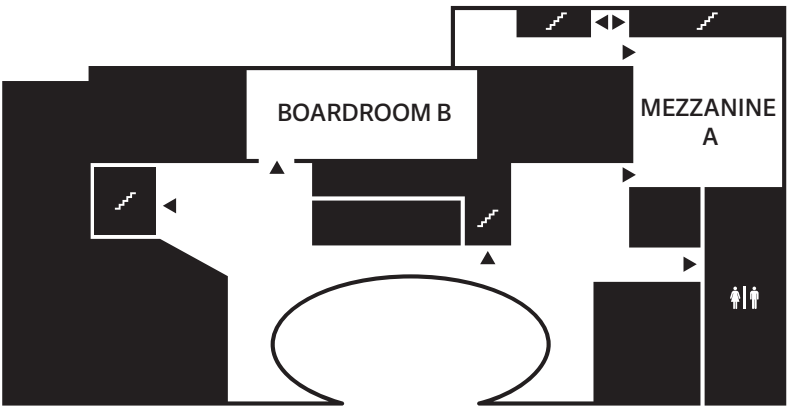

MEZZANINE LEVEL (+2)

WORKSHOP 1 – BALLROOM I
WORKSHOP 2 – BALLROOM II
WORKSHOP 3 – RITZ CARLTON B
WORKSHOP 4 – BALLROOM III
WORKSHOP 5 – RITZ CARLTON C
WORKSHOP 6 – BOARDROOM B
WORKSHOP 7 – MEZZANINE A
WORKSHOP 8 – RITZ CARLTON A

# 4 Workshops Program

## WORKSHOP 1

### **Innovations in service delivery and performance management**

**Chair:** Professor Graham Currie

**Rapporteur:** Rico Merkert

**Location:** Ballroom I

This workshop covers new management tools and technologies available to both operators and regulators to improve customer service. It includes a discussion of Key Performance Indicators (KPIs) in contracts (including monitoring regimes) and consideration of performance incentives for growing patronage, improving reliability, reducing overcrowding and improving other aspects of service quality.

## WORKSHOP 2

### **Effective institutional relationships, regulatory frameworks and contract transition strategies**

**Chair:** Wijnand Veeneman

**Rapporteur:** Andrew Smith

**Location:** Ballroom II

*With simultaneous interpretation English–Spanish  
(traducción simultánea Inglés-Español)*

This workshop will build on Workshop 5 from Thredbo 13, examining the roles and responsibilities of government, operators (including infrastructure managers) and third parties focusing on improving institutional relationships. It will address how to develop and improve regulatory frameworks, including in cases with limited public sector institutional capacity. We welcome research on improving organizational capacity for both regulators and firms. This workshop will continue to review experiences with different models for public transport provision with a particular focus on those initiated by authorities. It will examine developments in contracting, licensing provisions, economic regulation and the role of incentives to encourage high quality provision. There has been growing interest in the transition costs of change at a variety of levels from regime change to the change of operators within a contracting regime. It is hoped that this workshop will provide new evidence on disruption costs and on how these costs might be reduced.

## WORKSHOP 3

# Sustainable funding sources, and related cost/benefit measurements, for public transport

**Chair:** John Stanley  
**Rapporteur:** Professor David Levinson  
**Location:** Ritz Carlton B

The issue of paying for public transit is perennial. This workshop will focus on sustainable funding, both in the sense of funding that is reliable over time, and also that advances sustainability goals for transportation. We welcome papers that propose or evaluate new or refined methods to measure the costs and benefits of public transit and how these measures can be monetized to assist with system/service funding.

## WORKSHOP 4

# Developing inter-modal transport systems

**Chair:** Professor Stephen Ison  
**Rapporteur:** Lake Sagaris  
**Location:** Ballroom III  
*With simultaneous interpretation English–Spanish  
(traducción simultánea Inglés-Español)*

Public transport systems have been slow to address the dilemmas inherent in making their systems comfortable, direct, reliable and door-to-door, all key characteristics of “automobility”, the socio-technological phenomenon they seek to replace. Yet the future of public transport requires truly intermodal systems, with appropriate land use decisions and seamless transfers between the mode appropriate for a specific traveller, trip type, purpose or distance. Intermodal transport requires planning public space to optimize walkability and cycle-inclusion, which involves private bicycles, bikeshare, bicycle rickshaws, clean-running (usually electric or CNG) two- and three-wheelers, shared taxis and car sharing, in addition to traditional modes of public transit. It also requires different scales of governance and private operation, including micro and small businesses, cooperatives and other business models. Different owners and operators of specific modes can foster or limit the development and cooperation needed for multi-modal planning and intermodal service delivery. This workshop will examine the social, political, institutional, regulatory, and operational challenges to providing inter-modal transport. Is current thinking about “social sustainability” and transport sufficient? What are our definitions of “sustainability” missing, when it comes to scale, inclusion, health, resilience?

## WORKSHOP 5

### Harnessing big data

**Chair:** Marcela Munizaga

**Rapporteur:** Gabriel Sánchez-Martínez

**Location:** Ritz Carlton C

We are facing the new availability of multiple data sources, automatically generated as side products of the operation the public transport system (automatic fare collection, automatic vehicle location, automatic passenger counting) and also from technological devices external to the public transport system (mobile phone, private GPS, Bluetooth). These data sources can be used to help both agencies and operators better track performance and passenger behavior, and understand the market and needs of trip-makers. This workshop will cover both applications and challenges of using these large datasets offline and in real time in order to improve service. We also welcome papers addressing the regulatory and access issues of data and the relationship between open data and competition.

## WORKSHOP 6

### Reassessing public operations

**Chair:** Laurel Paget-Seekins

**Rapporteur:** Professor Jackie Walters

**Location:** Boardroom B

This workshop will revisit the question of whether to contract or publicly operate urban transit services, particularly within the context of the transition to formalized services in developing cities. This transition generates a range of issues from operational challenges to institutional capacity and political obstacles that impact the decision and the outcome of the ownership of operations question. We hope to generate a body of research that will help decision-makers to make whether to contract or publicly operate a deliberate policy decision. We welcome papers that discuss the complexities of formalization and how they impact the ownership of operations question, and evaluations of existing contracted or publicly operated services.

## WORKSHOP 7

### Market initiative: regulatory design, implementation and performance

**Chair:** Professor John Preston

**Rapporteur:** Didier van de Velde

**Location:** Mezzanine A

This workshop will build on Workshop 4 from Thredbo 13, discussing the current functioning and regulatory options for regimes where autonomous market-initiative plays a role (i.e., initiatives that do not result from competitive tendering). This could be the main institutional feature (deregulated regime) but it could also be hybrid regimes where market-initiative constitutes a marginal or additional feature to market organised by contracting/tendering (e.g., complementary chain services with shared ride or shared vehicles, local community initiatives in addition to regular public transport, etc). The workshop will cover all modes (bus, coach and rail) and both local and long-distance markets. Case studies of both good and bad practices will be presented to enlighten this debate, addressing in particular: the issue of coordination between services (is it needed or not? does regulation lead to improved performance?), performance of hybrid regimes, issues of concentration and competition, regulatory skills required for success, and balance between regulatory guidance through prohibition and guidance through financial and other incentives.

## WORKSHOP 8

### The wider economic, social and environmental impacts of public transport investment

**Chair:** Professor Corinne Mulley

**Rapporteur:** Glen Weisbrod

**Location:** Ritz Carlton A

This workshop will look at how countries (both developed and developing) now consider wider land use, social inclusion, environmental, and agglomeration issues and how these and the economic impacts of new infrastructure can be used to complement cost benefit decisions on public transport investment. On the one hand, developing countries are in many cases rapidly moving to a dominance of car-based passenger transport as a result of growing incomes and lack of collective transport alternatives. On the other hand, developed countries are now looking to reduce car dominance and increase the use of public transport and active transport as a measure to improve wellbeing and reduce greenhouse gas emissions. This workshop will seek to understand the broader context of these trends and their impact on externalities such as social inclusion, equity, housing, employment and the environment, as well as considering how these trends impact on the economy in question and on the decision as to what public transport investment regime to implement.

# 5 Biographies

## 1) PLENARY SPEAKERS



### **MICHÈLE DIX**

Managing Director of Crossrail 2 (formerly Managing Director of Planning) of Transport for London and has been recognised with a CBE (Commander of the Order of the British Empire) in the Queen's New Year's Honours list for services to transport in London on 2015. She will give a plenary address on the last day of the conference. Michèle has led Transport for London's strategic thinking on the future transport needs of London, testing and challenging solutions and providing clear direction on appropriate transport solutions for the future.



### **ANDRÉS GÓMEZ-LOBO**

Chile's Minister of Transport and Telecommunications. He was chief of staff of the Ministry of Transport between 2008 and 2010. As a consultant, Gómez-Lobo has advised public and private organizations on issues of infrastructure, natural resources, grants, public transport and telecommunications, including the World Bank, National Economic Prosecutor, Civil Aeronautics Board and Ministry of Public Works. He has served as Academic Director of the Masters in Public Policy and Academic Director of the Diploma in Territorial Policies, Urban and Environmental Faculty of Economics, University of Chile.



### **GLEN WEISBROD**

President of Economic Development Research Group, based in the US. He has worked for the past 37 years on economic impact and benefit evaluation for a wide variety of transport, energy and economic development programs and projects. His work on this topic has spanned Japan, South Africa, India, Australia, Netherlands, Scotland, England, Canada and the US. He has also authored several guides pertaining to the measurement and implications of wider benefits and economic development impacts of infrastructure investments. Glen was formerly Chair of the Committee on Transportation and Economic Development of the US Transportation Research Board.

## 2) ROUNDTABLE CONTRIBUTORS



### **HÉCTOR MOYA MARTÍN**

President of the Association of Urban Surface Transport Concessionaries will contribute to the operators' roundtable on the first day of the conference. Hector has worked in the transport industry since 1975 including as CEO of Transportes Frigoríficos Moya Ltd and Director of METBUS. He has been a leader in Chile's transport trade union movement serving at various times as President of the Confederation of Truck Owners of Chile, the Chilean Federation of Transport Unions, and CONAPYME.



### **JESÚS PADILLA ZENTENO**

President of CISA (BRT Operator in Ciudad de Mexico, Mexico) and President of the Mexican Association of Transport and Mobility, will contribute to the operators' roundtable on the first day of the conference. Jesús is also the Vice-President of the Latin American division of the International Association of Public Transport (UITP), an NGO with more than 90 years of experience dedicated to the exchange of information and best practices on transport and mobility policies between authorities and operators in Europe, Africa, Oceania, the Middle East and Latin America.



### **NEIL SMITH**

Neil Smith will contribute to the operator roundtable on the first day of the conference. Neil is the Director of Transit Systems, a 100% Australian owned family company, founded in 1995 to operate bus services in Perth, Western Australia. Transit Systems has grown to be one of Australia's most successful public transport providers, and is now the largest operator of 'franchised' urban bus services in Australia and has Australia's largest private fleet of passenger and vehicular ferries. Today, Transit Systems' operations are divided across seven bus and ferry transport businesses operating in Western Australia, South Australia, Queensland, New South Wales and the Northern Territory. Transit Systems also operates in the UK and Singapore under its associated company Tower Transit.



### 3) ROUNDTABLE: INCLUDING ALL STAKEHOLDERS



**MIGUEL MATUS**

He is a veteran of union organization in the transport sector in Santiago's public transport system, Transantiago. Drivers are on the frontline when it comes to customer relations and satisfaction, and hands-on knowledge about how systems are working and possible improvements, a source that is seldom tapped when planning sustainable transport improvements.



**ENRIQUE MONTALVA**

He is vice-president of the civil society council for the La Florida municipality on the southside of Metropolitan Santiago. With extensive experience as a local neighbourhood leader, he is now leading citizen involvement in these new instances, created by law to improve the interface between citizens and policymakers, in this case at a local municipality.



**LAUREL PAGET-SEEKINS**

Laurel Paget-Seekins is the Director of Strategic Initiatives at the Massachusetts Bay Transportation Authority. Laurel brings her experience in academia and as a community organizer to her new role trying to implement research based improvements to operations and policy at the 5th largest transit agency in the US. Prior to Boston, Laurel spent two years at the BRT Centre of Excellence in Santiago, Chile and is the co-editor of Restructuring Public Transport Through Bus Rapid Transit. Laurel has a Ph.D in Civil Engineering from the Georgia Institute of Technology.

## CHAIRS AND RAPORTEURS



### **PROFESSOR GRAHAM CURRIE**

Professor Currie is an international Public Transport research leader and policy advisor. He has published more research papers in leading peer research journals in this field than any other researcher in the world. He is founder of 'World Transit Research' ([www.worldtransitresearch.info](http://www.worldtransitresearch.info)) a free site to aid industry access to world research. Professor Currie is Associate Editor of the research Journal Transportation and Vice Chair of the Light Rail Transit Systems Committee at the US Transportation Research Board. He won the 2012 William B Millar Prize for best paper in Public Transportation at the TRB conference; the largest in the world.



### **PROFESSOR STEPHEN ISON**

Stephen Ison is Professor of Transport Policy in the Transport Studies Group, School of Civil and Building Engineering, Loughborough University, UK. He has published widely in the area of transport economics and policy, is a member of the Scientific Committee of the World Conference of Transport Research, Editor of the Journal of Research in Transportation Business and Management [Elsevier], Book Series Editor of Transport and Sustainability [Emerald Group Publishing] and has edited, authored or co-authored 7 books.



### **PROFESSOR DAVID LEVINSON**

Prof. David Levinson serves on the faculty of the Department of Civil, Environmental, and Geo- Engineering at the University of Minnesota and directs the Networks, Economics, and Urban Systems (NEXUS) research group. He holds the Richard P. Braun/CTS Chair in Transportation. Levinson has authored or edited several books including "The Transportation Experience" and "The End of Traffic and the Future of Transport", as well as numerous peer reviewed articles. He is the editor of the Journal of Transport and Land Use.



### **RICO MERKERT**

Dr Rico Merkert is Senior Lecturer and Coordinator of the PhD Program (Progressions) at the Institute of Transport and Logistics Studies at The University of Sydney, Australia. Rico is Co-Editor of the Journal of Air Transport Management, a Fellow of The Higher Education Academy and an appointed member of two U.S. Transportation Research Board (TRB) standing Committees. He has been involved in a number of projects on benchmarking, transport economics, efficiency analysis, policy and management for a range of clients such as the European Commission, Transport for NSW, Volvo Foundation and a number of major ground transport and aviation companies.



**PROFESSOR CORINNE MULLEY**

Professor Corinne Mulley is the founding Chair in Public Transport at the Institute of Transport and Logistics Studies (ITLS). As a transport economist she has researched and published at the interface of transport policy and economics, in particular on issues relating to public transport. Since taking up her post at ITLS in Sydney, Corinne has been involved with State government on the development of transport plans and other studies, the independent regulators, local government, community transport organisations and community groups.



**MARCELA MUNIZAGA**

Marcela Munizaga is Associate Professor at Universidad de Chile. Specialist on transport demand modeling, predictive models and microeconomic analysis applied to private and public transport. In the last few years has leaded research on smartcard data and developed applications to obtain valuable information from automatically generated databases, which have been transferred to practice and used for planning purposes. Has been advisor to the Chilean Minister of Transport, and participated as transport demand expert in consultancy projects and specialists panels. Currently is Co-Chair of the International Steering Committee for Travel Survey Conferences ISCTSC and Co-Editor of Ingeniería de Transporte (Spanish language journal).



**LAUREL PAGET-SEEKINS**

Laurel Paget-Seekins is the Director of Strategic Initiatives at the Massachusetts Bay Transportation Authority. Laurel brings her experience in academia and as a community organizer to her new role trying to implement research based improvements to operations and policy at the 5th largest transit agency in the US. Prior to Boston, Laurel spent two years at the BRT Centre of Excellence in Santiago, Chile and is the co-editor of Restructuring Public Transport Through Bus Rapid Transit. Laurel has a Ph.D in Civil Engineering from the Georgia Institute of Technology.



#### **PROFESSOR JOHN PRESTON**

John Preston is Professor of Rai Transport and Head of the Transportation Group at the University of Southampton. He has over 30 years of experience in transport research and education, having previously held posts at the Universities of Leeds and Oxford, and is an ever present at the Thredbo Conference series. His research in transport covers demand and cost modelling, regulatory studies, land-use and environment interactions and economic appraisal and evaluation. His initial work concentrated on rail but subsequent work has covered all the major modes of transport. He has held over 130 research grants and contracts, worth almost £10 million, and has published over 260 articles, book chapters, conference and working papers.



#### **LAKE SAGARIS**

Lake Sagaris is an internationally recognized expert on cycle-inclusive urban planning, civil society development, and participatory planning theory and practice. She began her working life in Chile in 1980, working as a freelance journalist for the London Times, Toronto Globe and Mail, Miami Herald, and other media. She holds a Master's of Science (University of Toronto 2006) and a PhD in Urban Planning and Community Development (University of Toronto 2012). Her current work uses participatory action research methods and community-government partnerships to advance toward more sustainable transport, with a strong focus on social justice, inclusion and resilience. These experiences have led to awards in Chile and abroad, and presentations in diverse venues in Latin America, Europe, Canada, and India.



#### **GABRIEL SÁNCHEZ-MARTÍNEZ**

Gabriel Sánchez-Martínez is a lecturer and research associate at the Massachusetts Institute of Technology (MIT) with expertise in information technology applications for public transportation operations. His work integrates optimization, simulation modeling, and computational analysis of transit data. Gabriel teaches Public Transportation Systems. He is a National Science Foundation graduate research fellow and an Eno fellow. He holds an MS and a PhD in Transportation from MIT and a BS in Civil Engineering from the University of Puerto Rico, Mayagüez.



**ANDREW SMITH**

Andrew is a Senior Lecturer in Transport Regulation and Economics and Research Group Leader for the Economics and Discrete Choice Research Group at the Institute for Transport Studies, University of Leeds. He is a leading academic in the field of rail cost and efficiency modelling, infrastructure access pricing and marginal cost research, rail regulation and the impact of rail reforms on economic efficiency. He has led or is leading a wide range of rail cost modelling projects, funded by, for example, the European Commission, EPSRC, the British Office of Rail Regulation, and the UK Department for Transport. Andrew's research also extends to efficiency and performance analysis in other sectors: Andrew is academic advisor on econometric benchmarking issues for OFWAT; and is currently undertaking an efficiency study on Community Hospitals funded by the National Institute for Health Research (NIHR). He also has a visiting research position at the Centre for Transport Studies in Stockholm.



**JOHN STANLEY**

John joined the Institute of Transport and Logistics Studies at University of Sydney in July 2008 as Adjunct Professor, after nine years as Executive Director of Bus Association Victoria and eight as Deputy Chair of Australia's National Road Transport Commission. He is a member of the Ministerial Advisory Committee advising Victoria's Minister for Planning on Melbourne's Metropolitan Planning Strategy and is co-author of the book, *An Introduction to Transport Policy*. He is a member of the Thredbo International Organizing Committee and was awarded an Australian Centenary Medal for services to public transport and conservation.



**DIDIER VAN DE VELDE**

Didier van de Velde is researcher at Delft University of Technology (Faculty of Technology, Policy and Management) and director of inno-V, a Dutch consultancy bureau specialized in public transport (policy, planning and competitive tendering). Didier is an expert on institutional reforms and competition in public transport and rail. He likes to analyse and bring structure in complex issues and developed the STO (strategic, tactical, operational) framework now widely used by PT researchers. He advised local, national and international authorities on reforms and contracting. His research interests also include railway unbundling and the economic effects of vertical separation in the railway sector.



**PROFESSOR WIJNAND VEENEMAN**

Wijnand Veeneman is associate professor at Delft University of Technology. Together with his PhDs he researches governance of infrastructure sectors, with a focus on public transport. He teaches governance for complex projects in Delft and at Shell. He is the Chair of the Dutch Advisory Committee on the Netherlands Institute of Government, and has been advising governments and operators on their relation in tendered and not tendered environments, in decision-making, development, construction, operation and evaluation phases. His current work includes advising the Dutch national parliament on complex rail projects, the European Union on financing sustainable transport, and Israel on restructuring their relation with their rail operation. He is involved in a European project on developing a data platform for innovative travel integrated advice, obviously with a focus on governance. His recent academic interest focuses in the role of organisational conflict in governance.

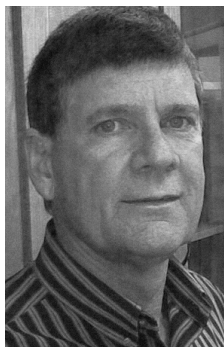

**PROFESSOR JACKIE WALTERS**

Professor Walters is the Chair of the Department of Transport and Supply Chain Management at the University of Johannesburg and the Director of the Institute of Transport and Logistics Studies (ITLS(Africa)), a research unit working in close collaboration with ITLS at the University of Sydney. His academic speciality includes public transport and aviation policy studies, as well as transport economics and logistics. He has been a specialist adviser to the Southern African Bus Operators Association since 1989 and participates in a number of governmental committees related to transportation matters.



**GLEN WEISBROD**

President of Economic Development Research Group, based in the US. He has worked for the past 37 years on economic impact and benefit evaluation for a wide variety of transport, energy and economic development programs and projects. His work on this topic has spanned Japan, South Africa, India, Australia, Netherlands, Scotland, England, Canada and the US. He has also authored several guides pertaining to the measurement and implications of wider benefits and economic development impacts of infrastructure investments. Glen was formerly Chair of the Committee on Transportation and Economic Development of the US Transportation Research Board.



# 6

# Attendees

THIS LIST WAS ELABORATED WITH PARTICIPANTS REGISTERED UNTIL AUGUST 10

**Mr. Pekka Aalto**

FINNISH PUBLIC TRANSPORT ASSOCIATION  
pekka.aalto@plly.fi

**Mr. Andres Alcala**

CAF  
aalcala@caf.com

**Ms. Julie Alexander**

NZTA  
julie.alexander@nzta.govt.nz

**Dr. Gunnar Alexandersson**

SWEDISH GOVERNMENT OFFICES  
gunnar.alexandersson@regeringskansliet.se

**Mr. Jaime Allen**

PONTIFICIA UNIVERSIDAD CATÓLICA DE CHILE  
jallen@uc.cl

**Mr. Giorgio Ambrosino**

MEMEX SRL  
giorgio.ambrosino@memexitaly.it

**Dr. Jeremy Anderson**

ITF  
anderson\_jeremy@itf.org.uk

**Mr. Matts Andersson**

KTH - ROYAL INSTITUTE OF TECHNOLOGY  
matts.andersson@wspgroup.se

**Mr. Tero Anttila**

HELSINKI REGION TRANSPORT (HSL/HRT)  
tero.anttila@hsl.fi

**Mr. Rodolfo Arriagada Cura**

PONTIFICIA UNIVERSIDAD CATÓLICA DE CHILE  
rac@ing.puc.cl

**Ms. Jacqueline Grace Arriagada**

UNIVERSIDAD DE CHILE  
afjg.7440@gmail.com

**Mr. Nicolás Badiola**

PONTIFICIA UNIVERSIDAD CATÓLICA DE CHILE  
nbadiola@gmail.com

**Ms. Therese Bajada**

UNIVERSITY COLLEGE LONDON  
therese.bajada.10@ucl.ac.uk

**Dr. David Bray**

UNIVERSITY OF QUEENSLAND  
d.bray1@uq.edu.au

**Mr. Guido Bruggeman**

INDEPENDENT TRANSPORT CONSULTANT  
guido.bruggeman@planet.nl

**Mr. Christopher Bucknell**

CEDEUS  
cbr@ing.puc.cl

**Dr. Lucy Budd**

LOUGHBOROUGH UNIVERSITY  
l.c.s.budd@lboro.ac.uk

**Mr. Carlos Bueno**

PONTIFICIA UNIVERSIDAD CATÓLICA DE CHILE  
cebueno@uc.cl

**Mr. Owen Bull**

PONTIFICIA UNIVERSIDAD CATÓLICA DE CHILE  
ombull@uc.cl

**Dr. Carolina Camén**

KARLSTAD UNIVERSITY / SAMOT  
carolina.camen@kau.se

**Dr. Juan Antonio Carrasco**

UNIVERSIDAD DE CONCEPCIÓN  
j.carrasco@udec.cl

**Ms. Cécile Chèze**

LET/CNRS  
cecile.cheze@gmail.com

**Dr. Demi Chung**

UNSW  
demi.chung@unsw.edu.au

**Dr. Geoffrey Clifton**

UNIVERSITY OF SYDNEY  
geoffrey.clifton@sydney.edu.au

**Ms. Benedicte Colin**

KEOLIS DOWNER PTY LTD  
paula.mckain@keolisdowner.com.au

**Mr. Jonathan Cook**

KEOLIS DOWNER PTY LTD  
chelsea.price@keolisdowner.com.au

**Dr. Cristian Cortes**

UNIVERSIDAD DE CHILE  
ccortes@ing.uchile.cl

**Mr. Nicolaas Cronje**

GOLDEN ARROW BUS SERVICES  
niccronje@gabs.co.za

**Mr. Ricardo Andrés Cubillos**

UNIVERSIDAD DE CHILE  
ricardocubillos@gmail.com

**Ms. María Alejandra Cuevas de la Fuente**

PONTIFICIA UNIVERSIDAD CATÓLICA DE CHILE  
alejandracuevas@uc.cl

**Professor Graham Currie**

PUBLIC TRANSPORT RESEARCH GROUP MONASH UNIVERSITY  
graham.currie@monash.edu

**Mr. Simon Dale**

LOUGHBOROUGH UNIVERSITY  
Simon.Dale@nottinghamcity.gov.uk

**Mr. Hans Danielson**

K2 / DANIELSON & CO  
hans.danielson@danco.se

**Professor Joaquim de Aragão**

UNIVERSITY OF BRASILIA  
joaquim.jg.aragao@gmail.com

**Mr. Sebastián De Peña**

PONTIFICIA UNIVERSIDAD CATÓLICA DE CHILE  
sadepena@uc.cl

**Mr. Andrei Dementiev**

HIGHER SCHOOL OF ECONOMICS  
dementiev@hse.ru

**Dr. Michèle Dix**

TRANSPORT FOR LONDON  
micheledix@tfl.gov.uk

**Mr. Sergio Enrique Droguett**

UNIVERSIDAD DE CHILE  
sedroguet@ing.uchile.cl

**Ms. Elsa Durán**

UNIVERSIDAD DE CHILE  
elsa.adh@gmail.com

**Mr. Peter Dwyer**

PIPER ALDERMAN  
pdwyer@piperalderman.com.au

**Professor Ahmed El-Geneidy**

MCGILL UNIVERSITY  
ahmed.elgeneidy@mcgill.ca

**Mr. David Emerson**

UNIVERSITY OF SYDNEY  
d.emerson@econ.usyd.edu.au

**Mr. Bougna Tchofo Emmanuel**

LABORATORY OF TRANSPORT ECONOMICS  
emmanuel.bougna@let.ish-lyon.cnrs.fr

**Mr. Diego Espinoza**

UNIVERSIDAD DE CHILE  
despinozas@ing.uchile.cl

**Dr. Markus Fellesson**

KARLSTAD UNIVERSITY / SAMOT  
markus.fellesson@kau.se

**Professor Rodrigo Fernández**

UNIVERSIDAD DE LOS ANDES  
rfa@uandes.cl

**Mr. Santiago Fernandez Reyes**

MIT  
santfdz@mit.edu

**Mr. Clint Feuerherdt**

TRANSIT SYSTEMS  
vhorton@transitsystems.com.au

**Mr. Andres Fielbaum**

UNIVERSIDAD DE CHILE  
fielbaum@gmail.com

**Dr. Charles Fleurent**

GIRO INC.  
charles.fleurent@giro.ca

**Ms. Patricia Galilea**

PONTIFICIA UNIVERSIDAD CATÓLICA DE CHILE  
pgalilea@ing.puc.cl

**Mr. Diego García**

PONTIFICIA UNIVERSIDAD CATÓLICA DE CHILE  
digarcia@uc.cl

**Dr. Ricardo Giesen**

PONTIFICIA UNIVERSIDAD CATÓLICA DE CHILE  
giesen@ing.puc.cl

**Ms. Puay San Goh**

LAND TRANSPORT AUTHORITY  
goh\_puay\_san@lta.gov.sg

**Mr. Felipe Gonzalez**

PONTIFICIA UNIVERSIDAD CATÓLICA DE CHILE  
fagonza1@uc.cl

**Ms. María de los Ángeles González**

PONTIFICIA UNIVERSIDAD CATÓLICA DE CHILE  
angelesgk@gmail.com

**Dr. Antonio Gschwender**

DTPM / UNIVERSIDAD DE CHILE  
antonio.gschwender@dtpm.gob.cl

**Mr. Pablo Guarda**

CEDEUS  
paguarda@uc.cl

**Professor Laurent Guihery**

LET - CNRS - UNIV. LYON  
laurent.guihery@let.ish-lyon.cnrs.fr

**Mr. Olav Hauge**

MOLDE UNIVERSITY COLLEGE  
olav.hauge@himolde.no

**Dr. Brendon Hemily**

HEMILY AND ASSOCIATES  
brendon.hemily@sympatico.ca

**Professor David Hensher**

UNIVERSITY OF SYDNEY  
david.hensher@sydney.edu.au

**Mr. Felipe Hernández**

UNIVERSIDAD DE CHILE  
cephei.1313@gmail.com

**Dr. Dario Hidalgo**

UNIVERSIDAD DE CHILE  
dhidalgo@embarq.org

**Mr. Fabio Hirschhorn**

RESEARCHER  
h.fabio@gmail.com

**Dr. Chinh Ho**

UNIVERSITY OF SYDNEY  
chinh.ho@sydney.edu.au

**Mr. Laurant Huefner**

SOUTH AUSTRALIAN BUS ASSOCIATION  
lhuefner@bussa.asn.au

**Mr. Vicente Huerta**

PONTIFICIA UNIVERSIDAD CATÓLICA DE CHILE  
vihuerta@uc.cl

**Dr. John Hultén**

K2-SWEDISH KNOWLEDGE CENTER FOR PUBLIC TRANSPORTATION  
john.hulten@k2centrum.se

**Dr. Ricardo Hurtubia**

PONTIFICIA UNIVERSIDAD CATÓLICA DE CHILE  
rhg@ing.puc.cl

**Ms. Gloria Hutt**

QUIZ CONSULTANTS  
gloria.hutt@gmail.com

**Professor Stephen Ison**

LOUGHBOROUGH UNIVERSITY  
s.g.ison@lboro.ac.uk

**Mr. Peter Kavanagh**

BUS ASSOCIATION VICTORIA  
pkavanagh@busvic.asn.au

**Professor Andreas Knorr**

GERMAN UNIVERSITY OF ADMINISTRATIVE SCIENCES  
knorr@dhv-speyer.de

**Dr. Homero Larrain**

PONTIFICIA UNIVERSIDAD CATÓLICA DE CHILE  
larrain@gmail.com

**Mr. Adam Daniel Leishman**

TOWER TRANSIT GROUP  
adam.leishman@towertransit.co.uk

**Dr. Wai Yan Leong**

LAND TRANSPORT AUTHORITY  
leong\_wai\_yan@lta.gov.sg

**Professor David Levinson**

UNIVERSITY OF MINNESOTA  
dlevinson@umn.edu

**Dr. Helene Lidestam**

LINKÖPING UNIVERSITY  
helene.lidestam@liu.se

**Ms. Jessica Lima**

UFPE  
delima.jh@gmail.com

**Professor Luis Antonio Lindau**

WRI BRASIL  
tlindau@embarqbrasil.org

**Mr. Todd Litman**

VICTORIA TRANSPORT POLICY INSTITUTE  
litman@vtpi.org

**Dr. Anders Ljungberg**

TRANSPORT ANALYSIS  
anders.ljungberg@trafa.se

**Mr. Zhi Zhan Lo**

LAND TRANSPORT AUTHORITY  
lo\_zhi\_zhan@lta.gov.sg

**Ms. Joo Hui Low**

LAND TRANSPORT AUTHORITY  
low\_joo\_hui@lta.gov.sg

**Mr. Chris Lowe**

BUS ASSOCIATION VICTORIA  
clowe@busvic.asn.au



## 14th International Conference on Competition and Ownership in Land Passenger Transport

**Mr. Samuel Lucas**

BUSLINK SUNRAYSIA  
sam.lucas@warbus.com.au

**Professor Andreas Lueg-Arndt**

FRANKFURT UNIVERSITY OF APPLIED SCIENCES  
lueg-arndt@fb3.fra-uas.de

**Professor Rosário Macário**

IST-ID  
rosariomacario@tecnico.ulisboa.pt

**Mr. Tatenda Mbara**

WRI ROSS CENTER FOR SUSTAINABLE CITIES  
tmbara@uj.ac.za

**Dr. Rico Merkert**

UNIVERSITY OF SYDNEY  
rico.merkert@sydney.edu.au

**Dr. Jun Mizutani**

KOBE UNIVERSITY  
jun@maritime.kobe-u.ac.jp

**Mr. Jaime Moya**

CEDEUS  
jma.cedeus@gmail.com

**Professor Corinne Mulley**

UNIVERSITY OF SYDNEY  
corinne.mulley@sydney.edu.au

**Dr. Marcela Munizaga**

UNIVERSIDAD DE CHILE  
mamuniza@ing.uchile.cl

**Mr. Juan Carlos Muñoz**

PONTIFICIA UNIVERSIDAD CATÓLICA DE CHILE  
jcm@ing.puc.cl

**Ms. Filipa Munoz**

PONTIFICIA UNIVERSIDAD CATÓLICA DE CHILE  
fili.munoz@gmail.com

**Mr. Mikel Murga**

MIT  
mmurga@mit.edu

**Mr. Jonathan Myers**

KEOLIS DOWNER PTY LTD  
jonathan.myers@keolisdowner.com.au

**Dr. Toshiyuki Nakamura**

KYOTO UNIVERSITY  
nakamura@trans.kuciv.kyoto-u.ac.jp

**Mr. Matías Navarro**

CEDEUS  
mns@ing.puc.cl

**Ms. Isidora Navarro Sudy**

PONTIFICIA UNIVERSIDAD CATÓLICA DE CHILE  
ilnavarr@uc.cl

**Professor John Nelson**

UNIVERSITY OF ABERDEEN  
j.d.nelson@abdn.ac.uk

**Mr. Themba Jeffrey Ngcobo**

CITY OF JOBURG, REA VAYA  
jeffng@joburg.org.za

**Mr. Markus Niehaus Del Solar**

PONTIFICIA UNIVERSIDAD CATÓLICA DE CHILE  
mkniehaus@gmail.com

**Mr. Henrik Nolmark**

VREF  
henrik.nolmark@vref.se

**Mr. Graham O'Donnell**

ODGS PTY LTD  
grahamo@bigpond.net.au

**Mr. Ignacio Oliva**

PONTIFICIA UNIVERSIDAD CATÓLICA DE CHILE  
ign.oliva@gmail.com

**Mr. Jorge Órdenes**

UNIVERSIDAD DE CHILE  
ordenesjorge@gmail.com

**Ms. Yoseli Carolina Orozco Ledezma**

MER TELECOM CHILE  
yoseli.orozco@mer-chile.cl

**Mr. Jesús Padilla**

CORREDOR INSURGENTES SA DE CV  
jpadilla@ci-sa.com.mx

**Dr. Laurel Paget-Seekins**

MBTA  
lpaget@uc.cl

**Ms. Carolina Peña**

PONTIFICIA UNIVERSIDAD CATÓLICA DE CHILE  
cfpena@uc.cl

**Mr. Guillermo Petzhold**

WRI BRASIL  
gpetzhold@embarqbrasil.org

**Professor Pundy Pillay**

WITS UNIVERSITY  
pundy.pillay@wits.ac.za

**Mr. Juan Claudio Pinto**

METBUS  
jcpinto@metbus.cl

**Professor John Preston**

UNIVERSITY OF SOUTHAMPTON  
jpreston@soton.ac.uk

**Mr. Martín Quiroz**

MIT  
martin.quirozv@gmail.com

**Ms. Rhonda Renwick**

LVBL  
rrpc@bigpond.com

**Mr. Ignacio Riquelme**

UNIVERSIDAD DE CHILE  
igriquel@ing.uchile.cl

**Mr. Nicolás Rosales**

ASOCIACIÓN MEXICANA DE TRANSPORTE Y MOVILIDAD A.C.  
niconarp@hotmail.com

**Mr. Tomas Rossetti Youlton**

PONTIFICIA UNIVERSIDAD CATÓLICA DE CHILE  
terosset@uc.cl

**Mr. Stephen Rowe**

BUSWAYS GROUP  
sharonbrookes@busways.com.au

**Mr. Byron Rowe**

BUSWAYS GROUP  
sharonbrookes@busways.com.au

**Dr. Lake Sagaris**

PONTIFICIA UNIVERSIDAD CATÓLICA DE CHILE  
lsagaris@uc.cl

**Dr. Hiroki Sakai**

KOBE UNIVERSITY  
h-sakai@people.kobe-u.ac.jp

**Mr. Fred Salvucci**

MIT  
salvucci@mit.edu

**Dr. Gabriel Sánchez-Martínez**

MIT  
gsanmar@mit.edu

**Dr. Nobuhiro Sanko**

KOBE UNIVERSITY  
sanko@kobe-u.ac.jp

**Mr. Alejandro Schmidt**

CEDEUS  
asg@ing.puc.cl

**Dr. Hiroshi Shimamoto**

UNIVERSITY OF MIYAZAKI  
shimamoto@cc.miyazaki-u.ac.jp

**Dr. Andrew Simon John Smith**

UNIVERSITY OF LEEDS  
a.s.smith@its.leeds.ac.uk

**Mr. Neil Smith**

TOWER TRANSIT OPERATIONS LTD  
neil.smith@towertransit.co.uk

**Ms. Marielle Smith**

TRANSIT SYSTEMS  
vhorton@transitsystems.com.au

**Ms. Yeon-Jung Song**

KOBE UNIVERSITY  
mythcj@naver.com

**Mr. Jaime Soza Parra**

PONTIFICIA UNIVERSIDAD CATÓLICA DE CHILE  
jaime.sozaparra@gmail.com

**Professor John Stanley**

UNIVERSITY OF SYDNEY  
j.stan@bigpond.net.au

**Ms. Ruth Steel**

UNIVERSITY OF SYDNEY  
ruth.steel@sydney.edu.au

**Mr. Anson Stewart**

MIT  
ansons@mit.edu

**Dr. George Sun**

LAND TRANSPORT AUTHORITY  
george\_sun@lta.gov.sg

**Ms. Hilde Johanne Svendsen**

MOLDE RESEARCH INSTITUTE  
hilde.j.svendsen@himolde.no

**Ms. Alison Swee**

LAND TRANSPORT AUTHORITY  
alison\_swee@lta.gov.sg

**Professor Yoshinori Takahashi**

KINKI UNIVERSITY  
takahashi@bus.kindai.ac.jp

**Mr. Sebastián Tamblay**

CEDEUS  
stm.cedeus@gmail.com

**Mr. Edward Thomas**

YARRA TRAMS  
edward.thomas@yarratrams.com.au

**Dr. Alejandro Tirachini**

UNIVERSIDAD DE CHILE  
alejandro.tirachini@ing.uchile.cl

**Mr. Ignacio Tiznado**

PONTIFICIA UNIVERSIDAD CATÓLICA DE CHILE  
iatiznad@uc.cl

**Ms. Ignacia Torres**

PONTIFICIA UNIVERSIDAD CATÓLICA DE CHILE  
ignacia.torres@ing.puc.cl

**Mr. Vicente Torres Garibay**

PTV GROUP  
vicente.torres@ptvgroup.com

**Mr. Luis Trujillo Jorquera**

UNIVERSIDAD DE CHILE  
ltrujillo@ing.uchile.cl

**Professor Nick Tyler**

UNIVERSITY OF JOHANNESBURG  
n.tyler@ucl.ac.uk

**Mr. Alberto Urquiza**

REDBUS URBANO S.A.  
psq@redbusurbano.cl

**Professor Kiyohito Utsunomiya**

KANSAI UNIVERSITY  
t110025@kansai-u.ac.jp

**Dr. Alan Miguel Valdez**

THE OPEN UNIVERSITY  
alan.valdez@open.ac.uk

**Mr. Didier van de Velde**

DELFT UNIVERSITY OF TECHNOLOGY  
d.m.vandeveld@tudelft.nl

**Ms. Dea van Lierop**

MCGILL UNIVERSITY  
dea.vanlierop@mail.mcgill.ca

**Dr. Wijnand Veeneman**

DELFT UNIVERSITY OF TECHNOLOGY  
w.w.veeneman@tudelft.nl

**Mr. Rodrigo Vega**

PONTIFICIA UNIVERSIDAD CATÓLICA DE CHILE  
ravega@uc.cl

**Dr. Christoffel Venter**

UNIVERSITY OF PRETORIA  
christo.venter@up.ac.za

**Ms. Cecilia Viggiano**

MIT  
ceciliav@mit.edu

**Mr. Andreas Vigren**

VTI  
andreas.vigren@vti.se

**Mr. Natan Waintrub**

PONTIFICIA UNIVERSIDAD CATÓLICA DE CHILE  
nwaintrub@uc.cl

**Mr. Ian Paul Wallis**

IAN WALLIS ASSOCIATES  
ian@ianwallis.org

**Professor Jackie Walters**

UNIVERSITY OF JOHANNESBURG  
jwalters@uj.ac.za

**Ms. Shiqiao Wang**

UNIVERSITY OF TECHNOLOGY, SYDNEY  
shiqiao.wang@student.uts.edu.au

**Professor Mark Wardman**

UNIVERSITY OF LEEDS  
m.rwardman@its.leeds.ac.uk

**Mr. Philipp Wegelin**

LUCERNE UNIVERSITY OF APPLIED SCIENCES AND ARTS  
philipp.wegelin@hslu.ch

**Mr. Glen Weisbrod**

ECONOMIC DEVELOPMENT RESEARCH GROUP  
gweisbrod@edrgroup.com

**Mr. Jamie Whitmore**

WHITMORE GROUP - WHITMORES BUS LINES  
jamie@whitmoregroup.com.au

**Mr. Matthew Wilson**

PITCHER PARTNERS  
matthew.wilson@pitcher.com.au

**Dr. Anders Wretstrand**

K2 / LUND UNIVERSITY  
anders.wretstrand@tft.lth.se

**Professor Chris Zegras**

MIT  
czegras@mit.edu

# 7

## Michael Beesley Award

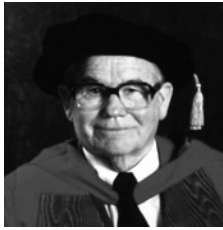

Professor Michael Beesley was one of the most influential transport economists of his time. He was the co-founder (with Professor David Hensher) of the Thredbo conference series. In 2005 the conference series' International Steering Committee established the Michael Beesley Award to pay tribute to his memory. The award recognises the best workshop paper presented at the conference by a person in the early stages of their career (first ten years). The person must be the primary author of the paper presented. The award is determined by the Michael Beesley Award Committee Chair (appointed by the Conference Chair) in consultation with all Workshop Chairs. The award recipient receives a trophy presented on the closing day of the conference at the conference dinner. Honourable mention may be made up to of two other authors who will receive certificates of recognition. All award recipients receive sponsored registration to the next conference in the series.

# 8

# Papers presented at Thredbo 14

**THIS LIST WAS ELABORATED WITH THE PAPERS RECEIVED UNTIL 10 AUGUST 2015**

**Development of Swedish railway organisation and policy - status report from ongoing Government Committee review**

GUNNAR ALEXANDERSSON  
Workshop 7 | Location: Mezanine A

**An innovative automatic certification tool for the assessment of Public Transport service performances indicators and the management of service contract**

GIORGIO AMBROSINO, BRENDAN FINN AND SAVERIO GINI  
Workshop 1 | Location: Ballroom I

**Enabling intermodal urban transport through complementary services: from Flexible Mobility Services to the Shared Use Mobility Agency**

GIORGIO AMBROSINO, JOHN D NELSON AND MARCO BOERO  
Workshop 4 | Location: Ballroom III

**A Big Bang in A Lazy Market: the Regulatory Reform of Finnish Bus Services in 2013-2014**

TERO ANTILA  
Workshop 2 | Location: Ballroom II

**BRT in Brazil: designing services in function of given infrastructure projects or designing infrastructure in function of established service quality patterns?**

JOAQUIM ARAGÃO, LEANDRO SILVA, YAEKO YAMASHITA AND ROMULO ORRICO FILHO  
Workshop 6 | Location: Boardroom B

**Modelling bus bunching using massive GPS and AFC data**

JACQUELINE ARRIAGADA, ANTONIO GSCHWENDER AND MARCELA MUNIZAGA  
Workshop 5 | Location: Ritz-Carlton B

**To contract or to operate publicly? Observations from the bus service reform transition process in Malta.**

THERESE BAJADA AND HELENA TITHERIDGE  
Workshop 6 | Location: Boardroom B

**Towards a liberalised European rail transport: Analysis and modelling the impact of competition on productive efficiency.**

EMMANUEL BOUGNA TCHOFO AND YVES CROZET  
Workshop 7 | Location: Mezanine A

**The politics of public transport funding: the case of the subsidy act in Chile**

JULIO BRIONES AND OWEN BULL  
Workshop 3 | Location: Ritz-Carlton B

**The impact on fare evasion of a credit-based fare system in Transantiago**

CHRISTOPHER BUCKNELL, JUAN CARLOS MUÑOZ, ALEJANDRO SCHMIDT AND MATIAS NAVARRO  
Workshop 3 | Location: Ritz-Carlton B

**Improving the environmental performance of Airport Surface Access in the UK: the role of public transport.**

LUCY BUDD, STEPHEN ISON AND THOMAS BUDD  
Workshop 4 | Location: Ballroom III

**Using GPS data to identify buses skipping formal stops**

OWEN BULL AND JUAN HERRERA  
Workshop 5 | Location: Ritz-Carlton B

**Subjective criteria in procurement of public bus transports**

CAROLINA CAMÉN AND HELENE LIDESTAM  
Workshop 1 | Location: Ballroom I

**Dominating factors contributing to the high(er) costs for public bus transports in Sweden**

CAROLINA CAMÉN AND HELENE LIDESTAM  
Workshop 6 | Location: Boardroom B

**A decision support system for managing disruptions in tram systems**

PAOLO CARNAGHI, ODED CATS AND WIJNAND VEENEMAN  
Workshop 1 | Location: Ballroom I

## 14th International Conference on Competition and Ownership in Land Passenger Transport

### **Public Private Partnerships: Shared value creation, trust and control**

DEMI CHUNG AND DAVID HENSHER  
Workshop 3 | Location: Ritz-Carlton B

### **An overview of enhanced bus services in Australian cities: What has been tried, what has worked?**

GEOFFREY T. CLIFTON AND CORINNE MULLEY  
Workshop 1 | Location: Ballroom I

### **Mixed integer programming approach for scheduling evasion-control inspectors in an integrated public transport system**

CRISTIÁN CORTÉS, DIEGO MUÑOZ, PABLO A REY, LUIS TRUJILLO AND SEBASTIÁN VALENZUELA RAMÍREZ  
Workshop 1 | Location: Ballroom I

### **Exploring Performance Outcomes and Regulator Contexts of Light Rail in Australia and the US**

GRAHAM CURRIE AND CHRIS DE GRUYTER  
Workshop 6 | Location: Boardroom B

### **Public transport's reliability: the case of Santiago, Chile**

CONSTANZA DANES AND JUAN CARLOS MUÑOZ  
Workshop 5 | Location: Ritz-Carlton B

### **Strategic partnership: a theory and evidence from suburban railway transport in Russia**

ANDREI DEMENTIEV  
Workshop 2 | Location: Ballroom II

### **A Case Study of an Individual Route Ownership business regime for public transport service delivery**

DAVID EMERSON, CORINNE MULLEY AND MICHIEL BLIEMER  
Workshop 7 | Location: Mezanine A

### **A theoretical analysis of business models for urban public transport systems, with comparative reference to the case of the Individual Line Ownership regime.**

DAVID EMERSON, CORINNE MULLEY AND MICHIEL BLIEMER  
Workshop 7 | Location: Mezanine A

### **Accessibility and transit performance**

ALIREZA ERMAGUN AND DAVID LEVINSON  
Workshop 3 | Location: Ritz-Carlton B

### **Appeals against public procurement processes: an empirical study of complainants' arguments and court decisions**

MAKUS FELLESSION AND CAROLINA CAMÉN  
Workshop 2 | Location: Ballroom II

### **Scheduled vs headway based operation: A hybrid approach**

DIEGO GARCÍA AND JUAN CARLOS MUÑOZ  
Workshop 1 | Location: Ballroom I

### **Real-Time Prediction of Bus Travel Speeds Using Traffic Shockwaves and Machine Learning Algorithms**

RICARDO GIESEN, NIKOLAS JULIO AND PEDRO LIZANA  
Workshop 5 | Location: Ritz-Carlton B

### **Using Increased Private Sector Involvement to Allow for Resource-Constrained Transit Growth**

MICHAEL GORDON, FREDERICK SALVUCCI AND JOHN ATTANUCCI  
Workshop 6 | Location: Boardroom B

### **Using smart card and GPS data for policy and planning: the case of Transantiago**

ANTONIO GSCHWENDER, MARCELA MUNIZAGA AND CAROLINA SIMONETTI  
Workshop 5 | Location: Ritz-Carlton B

### **Predicting fare evasion in urban bus systems**

PABLO GUARDA, JUAN DE DIOS ORTÚZAR, SUSAN HANDY, PATRICIA GALILEA AND JUAN CARLOS MUÑOZ  
Workshop 3 | Location: Ritz-Carlton B

### **New developement of intercity bus market in France : is it the comeback of the Road ?**

LAURENT GUIHERY  
Workshop 7 | Location: Mezanine A

### **An early analytical contribution for regulation of road congestion -**

OLAV HAUGE, SVEIN BRÅTHEN AND HARALD HJELLE  
Workshop 3 | Location: Ritz-Carlton B

### **Big Data vs. Little Data? Perspectives and Challenges for Public Transportation Agencies to Use ITS Data for Planning and Management**

BRENDON HEMILY  
Workshop 5 | Location: Ritz-Carlton B

### **Efficient Contracting and Incentive Agreements between Regulators and Public Transport Operators**

DAVID HENSHER AND CHINH HO  
Workshop 2 | Location: Ballroom II

#### **Disruption costs in Contract Transitions**

DAVID HENSHER, CORINNE MULLEY AND CHINH HO  
Workshop 2 | Location: Ballroom II

#### **Evaluating Public Transport Integration Scenarios**

DARIO HIDALGO AND JUAN M VELÁSQUEZ  
Workshop 6 | Location: Boardroom B

#### **A New Framework of Tasks and Roles for Public Transport Governance and a comparison between São Paulo and Amsterdam Metropolitan Regions – part 1"**

FABIO HIRSCHHORN AND WIJNAND VEENEMAN  
Workshop 2 | Location: Ballroom II

#### **The mobility challenge for regional communities: approaches to delivering sustainable public transport in sparse populations**

LAURAN HUEFNER  
Workshop 6 | Location: Boardroom B

#### **Transaction and transition costs during the deregulation of the Swedish Railway market**

STAFFAN HULTEN, GUNNAR ALEXANDERSSON AND MATTS ANDERSSON  
Workshop 7 | Location: Mezanine A

#### **How much public? How much private? In search of the balance that benefits users**

GLORIA HUTT AND PEDRO PABLO ERRAZURIZ  
Workshop 2 | Location: Ballroom II

#### **Obtaining a fair go for existing bus operators in a world of free trade**

PETER KAVANAGH  
Workshop 6 | Location: Boardroom B

#### **Intercity Bus Deregulation in Germany – Intramodal and Intermodal Effects After Two Years**

ANDREAS KNORR AND ANDREAS LUEG-ARNDT  
Workshop 7 | Location: Mezanine A

#### **When to provide express services for buses?**

HOMERO LARRAIN AND JUAN CARLOS MUÑOZ  
Workshop 3 | Location: Ritz-Carlton B

#### **Improving Bus Service Reliability: The Singapore Experience**

WAIYAN LEONG AND KAREN GOH  
Workshop 1 | Location: Ballroom I

#### **Better, Quicker, Together: piloting a mobile crowdsourcing approach to real-time sensing of transit service quality and customer satisfaction**

CORINNA LI, KALAN VISHWANATH, ZHENGQUAN QIN, FANG ZHAO, CHRISTOPHER ZEGRAS AND JINHUA ZHAO  
Workshop 1 | Location: Ballroom I

#### **Effective speed in a big city of Brazil: Computing the best modal to invest**

JESSICA LIMA AND MARIA LEONOR MAIA  
Workshop 8 | Location: Ritz-Carlton A

#### **Transforming bus transit in Brasilia: from conventional bus lines to a BRT integrated system**

LUIS ANTONIO LINDAU, CRISTINA ALBUQUERQUE, MAGDALA ARIOLI AND DANIELA FACCHINI  
Workshop 6 | Location: Boardroom B

#### **From planning to implementation: the successful case of Belo Horizonte's bus massive transit network**

LUIS ANTONIO LINDAU, DANIELA FACCHINI, NIVEA OPPERMANN, BRENDA MEDEIROS PEREIRA, ARIADNE AMANDA BARBOSA SAMIOS AND GUILLERMO PETZHOLD  
Workshop 4 | Location: Ballroom III

#### **Mega Events and the Transformation of Rio de Janeiro into a Mass-Transit City**

LUIS ANTONIO LINDAU, GUILLERMO PETZHOLD, VIRGINIA TAVARES AND DANIELA FACCHINI  
Workshop 4 | Location: Ballroom III

#### **When is a bus lane warranted**

TODD LITMAN  
Workshop 1 | Location: Ballroom I

#### **Comprehensive Evaluation of Completes Streets Policies; The Value of Designing Roads For Diverse Modes, Users and Activities**

TODD LITMAN  
Workshop 4 | Location: Ballroom III

#### **Marginal cost-pricing in the Swedish transport sector - an efficient and sustainable way of funding urban public transport**

ANDERS LJUNGBERG  
Workshop 3 | Location: Ritz-Carlton B

#### **Predictors of Bus Operator Community Interaction**

CHRISTOPHER LOWE  
Workshop 8 | Location: Ritz-Carlton A

## 14th International Conference on Competition and Ownership in Land Passenger Transport

### **Never miss a crisis: reforming urban mobility systems in Portugal**

ROSARIO MACARIO  
Workshop 2 | Location: Ballroom II

### **Tuk-tuk, 'a new kid on the block' in Johannesburg: Impacts and performance**

TATENDA MBARA  
Workshop 7 | Location: Mezanine A

### **The revenue potential and performance of BRT operations as part of larger transport systems**

RICO MERKERT, CORINNE MULLEY AND MAHBUBUL HAKIM  
Workshop 3 | Location: Ritz-Carlton B

### **Yardstick regulation and the operators' productivity of railway industry in Japan**

JUN MIZUTANI AND MUNEKATSU USAMI  
Workshop 2 | Location: Ballroom II

### **Analysing Stakeholders at a procurement procedure for urban services: Study case of Brasilia**

ARTUR MORAIS, ANÍSIO DOURADO, JOAQUIM ARAGÃO AND YAEKO YAMASHITA  
Workshop 6 | Location: Boardroom B

### **Passenger Flows Management by a Valve on Subway Platform**

JUAN CARLOS MUÑOZ, ARTURO DIDIER AND CONSTANZA SILVA DÍAZ  
Workshop 1 | Location: Ballroom I

### **Urban Public Transport Mileage Cards: Analysis of Their Potential with Smart Card Data and SP Survey**

TOSHIYUKI NAKAMURA, NOBUHIRO UNO, NATSUMI NAKAMURA, JAN-DIRK SCHMÖCKER AND TAKENORI IWAMOTO  
Workshop 5 | Location: Ritz-Carlton B

### **Super express services operated on urban highways: The opportunity of a new metropolitan transport mode**

MATIAS NAVARRO, JUAN CARLOS MUÑOZ, CHRISTOPHER BUCKNELL AND ALEJANDRO SCHMIDT  
Workshop 1 | Location: Ballroom I

### **Accessibility and equity indicators: approach for wider transport project assessment in Chile**

MARKUS NIEHAUS, PATRICIA GALILEA ARANDA AND RICARDO HURTUBIA  
Workshop 8 | Location: Ritz-Carlton A

### **Understanding cyclist traffic behaviour: contrasting cycle-path designs in Santiago de Chile**

MARKUS NIEHAUS, NATAN WAINTRUB, RODRIGO VEGA, CAROLINA PEÑA AND PATRICIA GALILEA  
Workshop 4 | Location: Ballroom III

### **Cycle-path design standards: a qualitative characterisation approach for cyclist flow in Santiago**

MARKUS NIEHAUS, NATAN WAINTRUB, RODRIGO VEGA, CAROLINA PEÑA AND PATRICIA GALILEA  
Workshop 4 | Location: Ballroom III

### **Using Least Present Value of Revenue auctions for Public Transport Infrastructure: The governance value of the flexible CAPEX**

MATHEUS OLIVEIRA, ROMULO ORRICO FILHO AND ROSÁRIO MACÁRIO  
Workshop 3 | Location: Ritz-Carlton B

### **Are we planning investments to fail? Consequences of traffic forecast effects on PPP contracts: Portuguese and Brazilian cases**

MATHEUS OLIVEIRA, JOANA RIBEIRO AND ROSÁRIO MACÁRIO  
Workshop 3 | Location: Ritz-Carlton B

### **Towards multi-modal integrated mobility systems: Opportunities for Panama city and Barranquilla**

ADRIANA ORTEGON AND NICK TYLER  
Workshop 4 | Location: Ballroom III

### **The publicness of public transport: the changing nature of public transport in Latin American cities**

LAUREL PAGET-SEEKINS AND MANUEL TIRONI  
Workshop 6 | Location: Boardroom B

### **Impact of integrated developments on transfer time**

DI PAN, GEORGE SUN AND TEIK-SOON LOOI  
Workshop 5 | Location: Ritz-Carlton B

### **Guidelines for BRT Contracts**

MARISA PEDRO AND ROSÁRIO MACÁRIO  
Workshop 2 | Location: Ballroom II

### **Designing a Pro-Poor Bus Fare Policy for the City of Johannesburg, South Africa**

PUNDY PILLAY AND LISA SEFTTEL  
Workshop 3 | Location: Ritz-Carlton B

### **Comparison of passengers' behavior and aggregate demand levels on a subway system using origin-destination surveys and smartcard data**

CRISTOBAL PINEDA, DANIEL SCHWARZ AND ESTEBAN GODOY  
Workshop 5 | Location: Ritz-Carlton B

**Big Buses in a Small Country: The Prospects for Bus Services in Wales.**

JOHN PRESTON  
Workshop 7 | Location: Mezanine A

**Deja Vu All Over Again? Rail Franchising in Britain.**

JOHN PRESTON, SIMON BLAINEY AND ALEJANDRO ORTEGA  
Workshop 2 | Location: Ballroom II

**Nudge, Nudge, Wink, Wink. Say no more. The impact of smarter choices on the use of active travel and public transport.**

JOHN PRESTON, ALAN WONG AND ADRIAN HICKFORD  
Workshop 1 | Location: Ballroom I

**Comparing Open and Closed BRT networks in medium-sized cities**

FRANCISCO PROBOSTE, JUAN CARLOS MUÑOZ AND ANTONIO GSCHWENDER  
Workshop 1 | Location: Ballroom I

**Transition to Government Contracting Model**

GOH PUAY SAN, SWEE ALISON, JOO HUI LOW AND WAI YAN LEONG  
Workshop 2 | Location: Ballroom II

**Bike-Bus Intermodal Integration: The Why, the What and the How**

LAKE SAGARIS AND ANVITA ARORA  
Workshop 4 | Location: Ballroom III

**Evaluating progressive contractual arrangement in Japanese publicly-owned bus sector**

HIROKI SAKAI  
Workshop 2 | Location: Ballroom II

**Optimal Allocation of Vehicles to Bus Routes Using Automatically Collected Data and Simulation Modeling**

GABRIEL SÁNCHEZ-MARTÍNEZ, HARIS N. KOUTSOPOULOS AND NIGEL H.M. WILSON  
Workshop 5 | Location: Ritz-Carlton B

**Increasing the speed: a case study from Santiago**

ALEJANDRO SCHMIDT, JUAN CARLOS MUNOZ, CHRISTOPHER BUCKNELL, MATIAS NAVARRO AND CAROLINA SIMONETTI  
Workshop 1 | Location: Ballroom I

**Analysis of the relationship between the public transit fare structure and passenger behaviour using a smart card data**

HIROSHI SHIMAMOTO AND ATSUSHI KONDO  
Workshop 5 | Location: Ritz-Carlton B

**The impact of economic regulation on the efficiency of European railway systems**

ANDREW SMITH, VALERIO BENEDETTO AND CHRIS NASH  
Workshop 2 | Location: Ballroom II

**Effects of Diversification Strategies on the Investment of Railway Business: The Case of Private Railway Companies in Japan**

YEON-JUNG SONG AND KENICHI SHOJI  
Workshop 7 | Location: Mezanine A

**Funding opportunities for Australian urban public transport**

JOHN STANLEY  
Workshop 3 | Location: Ritz-Carlton B

**CoAXs: interactive mapping for measuring and communicating transit's accessibility impacts to support co-creative planning**

ANSON STEWART AND P. CHRISTOPHER ZEGRAS  
Workshop 8 | Location: Ritz-Carlton A

**Does outsourcing of tendering processes in public transit enhance technical efficiency?**

HILDE JOHANNE SVENDSEN, ARILD HERVIK AND JAMES ODECK  
Workshop 2 | Location: Ballroom II

**The Role of Local Transport in the Solution for the Problem of Limited Access to Shopping Facilities**

YOSHINORI TAKAHASHI AND HIROKI SAKAI  
Workshop 1 | Location: Ballroom I

**Estimation of a zonal origin-destination matrix from observed public transport trips for Santiago de Chile**

SEBASTIÁN TAMBLAY, PATRICIA GALILEA AND JUAN CARLOS MUÑOZ  
Workshop 5 | Location: Ritz-Carlton B

**Estimation of travel time variability for public transport users in Santiago**

ALEJANDRO TIRACHINI AND ELSA DURÁN  
Workshop 1 | Location: Ballroom I

**Assessing transport disadvantage and transit use through people's knowledge, experience, and barriers to activities and modes**

ALEJANDRO TUDELA, JUAN ANTONIO CARRASCO AND RAUL BUSTAMANTE  
Workshop 8 | Location: Ritz-Carlton A



## 14th International Conference on Competition and Ownership in Land Passenger Transport

### **Social capital and local public transportation in Japan**

KIYOHITO UTSUNOMIYA  
Workshop 8 | Location: Ritz-Carlton A

### **Exploring crowdsourcing approaches to big data in Milton Keynes**

ALAN-MIGUEL VALDEZ AND STEHPEN POTTER  
Workshop 5 | Location: Ritz-Carlton B

### **Enjoying loyalty: The relationship between service quality, customer satisfaction, and behavioral intentions in public transit**

DEA VAN LIEROP AND AHMED EL-GENEIDY  
Workshop 1 | Location: Ballroom I

### **Coordinative organizational mechanisms in railway operation and planning: a conceptual framework**

WIJNAND VEENEMAN  
Workshop 2 | Location: Ballroom II

### **Developments in Public Transport Governance in the Netherlands; Recent Developments**

WIJNAND VEENEMAN AND DIDIER VAN DE VELDE  
Workshop 2 | Location: Ballroom II

### **Social, Environmental and Economic Benefits of Bus Rapid Transit**

JUAN M VELÁSQUEZ, ROBIN KING, AILEEN CARRIGAN AND DARIO HIDALGO  
Workshop 8 | Location: Ritz-Carlton A

### **Assessing the potential of bus rapid transit-led network restructuring for enhancing affordable access to employment – The case of Johannesburg's Corridors of Freedom**

CHRISTO VENTER  
Workshop 8 | Location: Ritz-Carlton A

### **Identifying opportunities for bus service expansion using automatically collected data**

CECILIA VIGGIANO, HARIS N. KOUTSOPOULOS, JOHN P. ATTANUCCI AND NIGEL H.M. WILSON  
Workshop 5 | Location: Ritz-Carlton B

### **Cost efficiency in tendered Swedish bus contracts**

ANDREAS VIGREN  
Workshop 2 | Location: Ballroom II

### **Demand and service impacts of competition for the market - Australian urban bus case studies**

IAN WALLIS  
Workshop 6 | Location: Boardroom B

### **Are South African small bus operators ready to participate in the formal public transport contracting system?**

JACKIE WALTERS AND LESIBA MANAMELA  
Workshop 6 | Location: Boardroom B

### **Preparation for implementing land value capture in Australia**

SHIQIAO WANG  
Workshop 3 | Location: Ritz-Carlton B

### **The impact of alternative governance forms of regional public transport on transaction costs. Case evidence from Germany and Switzerland**

PHILIPP WEGELIN AND WIDAR VON ARX  
Workshop 2 | Location: Ballroom II

### **Recognising the complementary contributions of Cost Benefit Analysis and Economic Impact Analysis to an understanding of the worth of public transport investment: A Case Study of Bus Rapid Transit in Sydney, Australia**

GLEN WEISBROD, DAVID HENSHER AND CORINNE MULLEY  
Workshop 8 | Location: Ritz-Carlton A

### **From production to service: novel ways of contracting public transport services in Sweden**

ANDERS WRETSTRAND AND HANS DANIELSON  
Workshop 7 | Location: Mezanine A

### **Deregulation in the Brazilian Interstate Coach Transport: A new perspective?**

YAEKO YAMASHITA, JOAQUIM ARAGAO, ROMULO ORRICO AND CRISTIANO ALMEIDA  
Workshop 7 | Location: Mezanine A



<b>1989</b>	<b>Thredbo, Australia</b>
1991	Tampere, Finland
1993	Toronto, Canada
1995	Rotorua, New Zealand
1997	Leeds, United Kingdom
1999	Cape Town, South Africa
2001	Molde, Norway
2003	Rio de Janeiro, Brazil
2005	Lisbon, Portugal
2007	Hamilton Island, Australia
2009	Delft, Netherlands
2011	Durban, South Africa
2013	Oxford, United Kingdom
<b>2015</b>	<b>Santiago, Chile</b>



## SUPPORTERS



## SPONSORS



the mind of movement

